

Durham Latch - Installation Guide

1. Using the template provided mark out the hole positions and drill holes.
2. Fit Latch Handle (In Closed Position) to door and position the Plastic Cup (**Tab downwards**); using fixing screws; tighten down (**Take care not to over-tighten**).
3. Fit brass drive. Fit Signal with RED section upwards.
4. Align the bottom of the Face Plate to the Cup Tab.
5. Carefully but firmly locate on the top rim of the Cup lip.
6. Ensure the Face Plate is positively and securely located. (**Do not use excessive force**)
7. Check for free movement of Latch.
8. Ensure the Signal indicates correctly 'WHITE 'OPEN' / RED 'CLOSED'

To remove Face Plate depress the Cup Tab using a small screwdriver and remove with care

NOTE:

FOR INWARD OPENING DOORS, FIT TO PILASTER.
FOR OUTWARD OPENING DOORS, FIT TO DOOR.

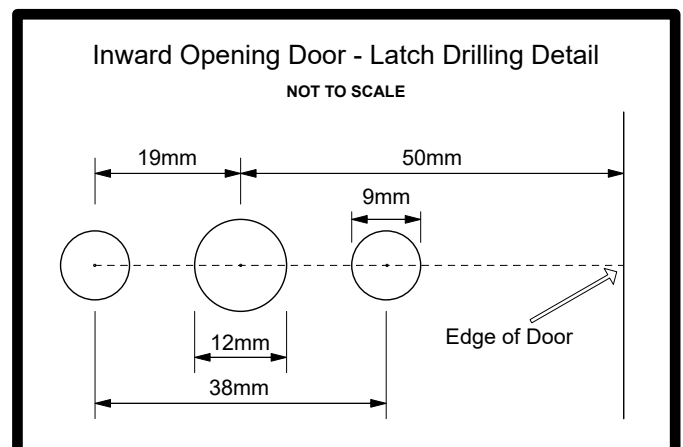
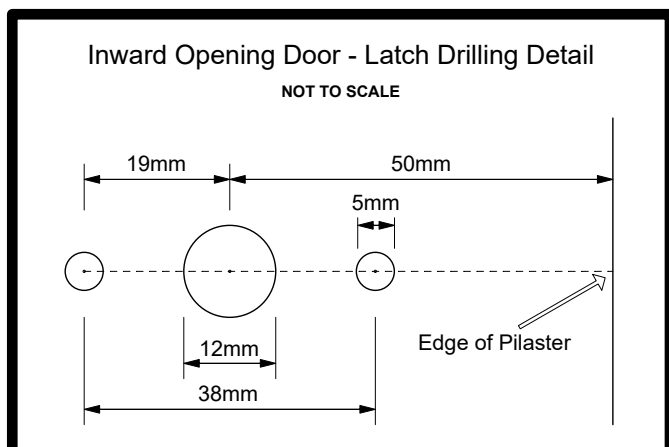
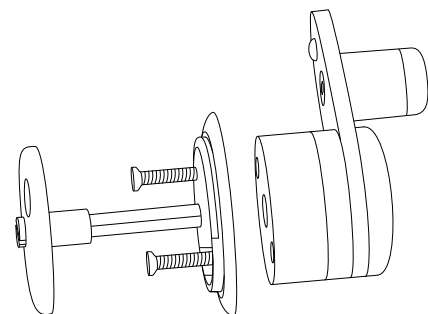
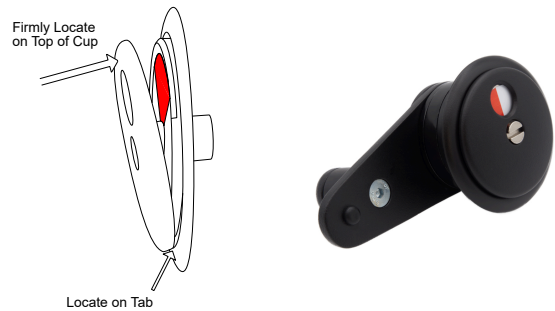
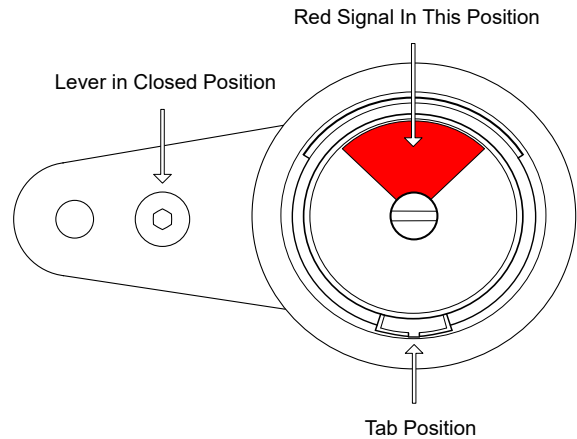

The drilling details above are for reference only.
To scale templates provided in each pack.