

Dudley



ELECTROFLO®

INFRARED TOUCH FREE FLUSH SENSOR



INSTALLATION GUIDE



IMPORTANT NOTES

Prior to installation ensure raised toilet seat will not cover sensor.

During installation do not expose the electronics to fluids, dust, dirt or damp.

Installation of the mains adaptor must be carried out and checked by a qualified electrician.

No after-market mains power packs to be used with this product. Use OEM supplied power pack only.

Do not kink or trim supplied air tubes.

1 PACK CONTENTS

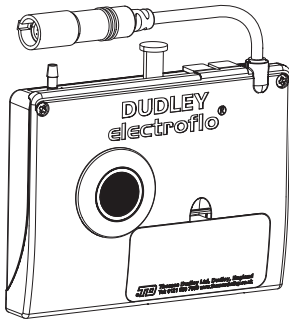

CONTROL UNIT



FIXING NUT

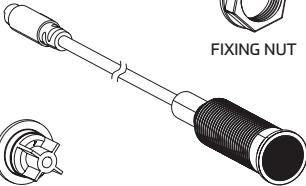

INFRA-RED
SENSOR WITH
CABLE



MOUNTING
ADAPTOR



DOMESTIC
SURROUNDS

[OR]



COMMERCIAL
SURROUNDS

2 SENSOR MOUNTED UNIT

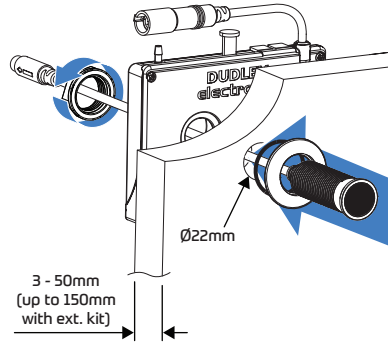

INDEPENDENTLY MOUNTED

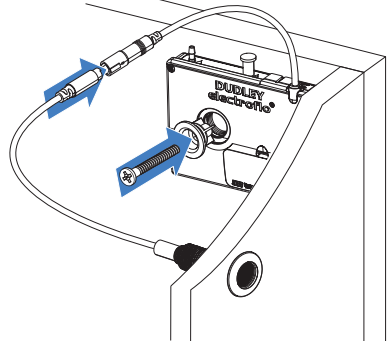

3 DOMESTIC SURROUNDS ONLY

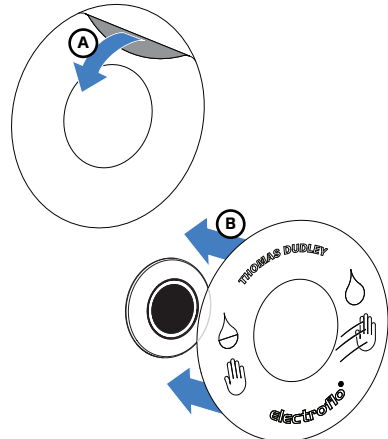

4 CONNECTIONS

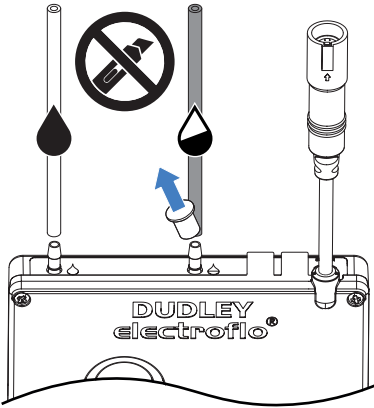

5a BATTERY POWER-UP

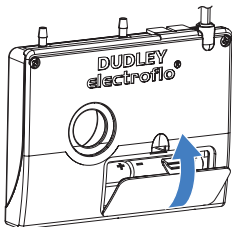
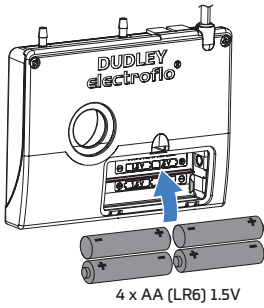
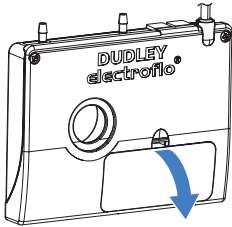

5b MAINS POWER-UP

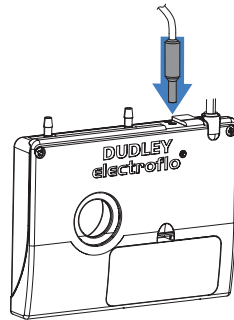
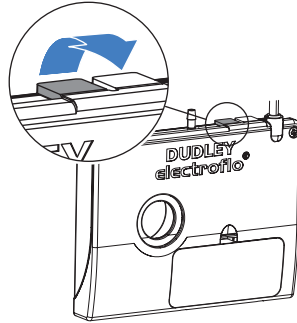

6 OPERATION AND INDICATION

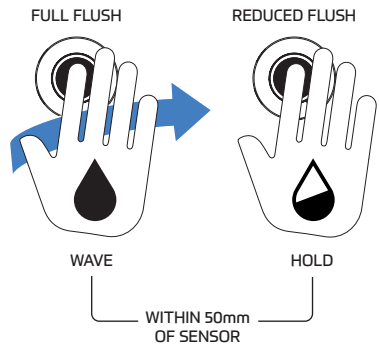

INDICATION	STATUS
LIT FOR 15 SEC. AFTER FLUSH	FILL DELAY
RAPID FLASH	BATTERY LOW
SLOW FLASH	SENSOR OBSTRUCTION

7 FLUSH CONVERSION

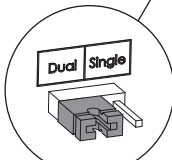
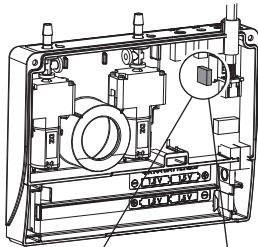
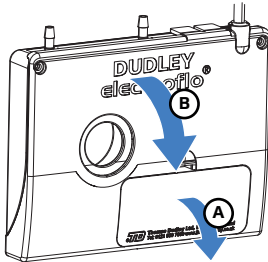
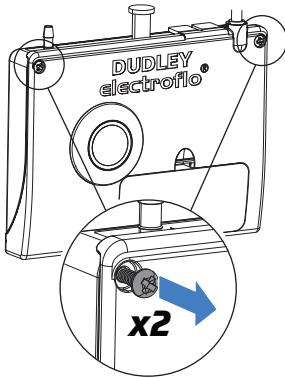

DUAL FLUSH

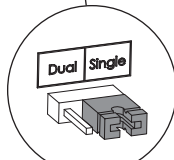

SINGLE FLUSH

8 PUMP BOOST

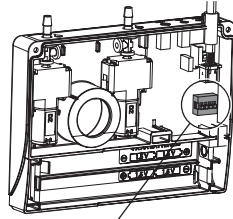

FULL FLUSH	REDUCED FLUSH	SWITCH SETTING	PUMP RUN TIME (SEC)
ON	OFF	OFF OFF	1.8
OFF	OFF	OFF ON	2.1
ON	ON	ON OFF	2.4
OFF	ON	ON ON	2.7

9 Final Installation Checklist

- ~ Check flush valve instructions for correct valve connection procedure.
- ~ Ensure air tubes are connected securely and routing is free from kinks and acute bends.
- ~ Check full and reduced flush operation.
- ~ Visit www.tyde.co.uk for service & maintenance information.

TYDE

295 Birmingham New Road
Dudley, West Midlands
United Kingdom
DY1 4SJ

A Thomas Dudley Business

t +44 (0)121 557 5411
f +44 (0)121 557 5345
e info@tyde.co.uk
w www.thomasdudley.co.uk/tyde

TYDE
fluid
movement