

Luxury straight stainless steel grab rail with concealed fixings



Product details

| | |
|--------------------------------|---------|
| Warranty: | 5 years |
| Max rated load: | 200 kg |
| Doc M compliant: | Yes |
| Suitable for wet areas: | Yes |

Features

- High quality stainless steel construction
- Concealed fixings
- Stylish T-bar design
- Complies with Part M of the Building Regulations

Finish options



Satin
Stainless Steel



Polished
Stainless Steel



Matt black
RAL 9005

Product description

| |
|---|
| Luxury grab rail, straight, stainless steel, concealed fixings, 355mm |
| Luxury grab rail, straight, stainless steel, concealed fixings, 480mm |
| Luxury grab rail, straight, stainless steel, concealed fixings, 620mm |
| Luxury grab rail, straight, stainless steel, concealed fixings, 900mm |

Product code

| |
|-----------|
| 311435/** |
| 311448/** |
| 311462/** |
| 311490/** |

Replace ** with finish option code above e.g., 311435/SP

Disclaimer

NYMAS Group makes every effort to ensure that the information provided on this data sheet is correct. However, we cannot guarantee this, and accept no liability for any information or advice given on this data sheet.

Dimensions (mm)

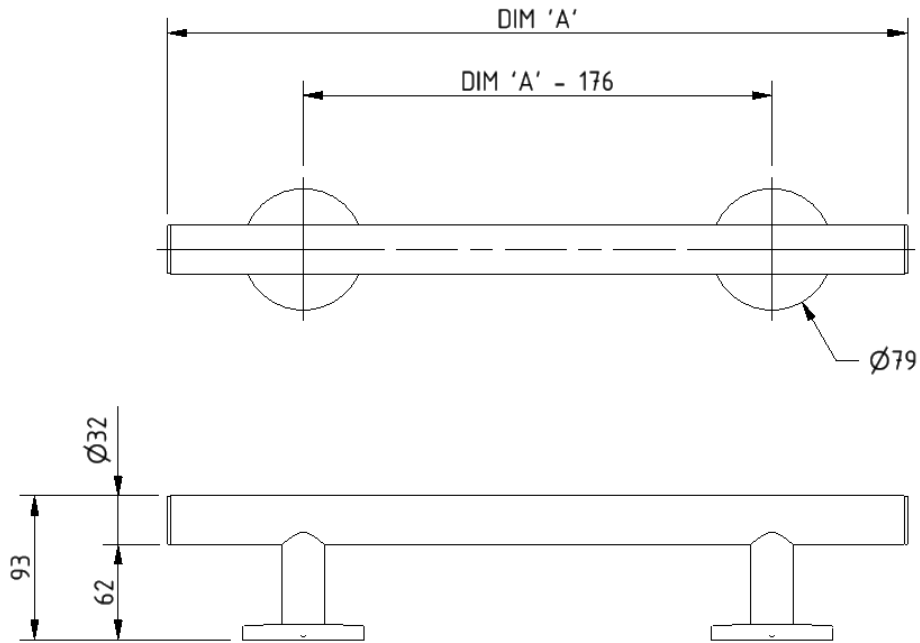

| PRODUCT CODE | 311435/** | 311448/** | 311462/** | 311490/** |
|--------------|-----------|-----------|-----------|-----------|
| DIM 'A' | 355 | 480 | 620 | 900 |