

Pacific Indicator Bolt 19mm - SAA

Product Code: 10501-19MM-SAA

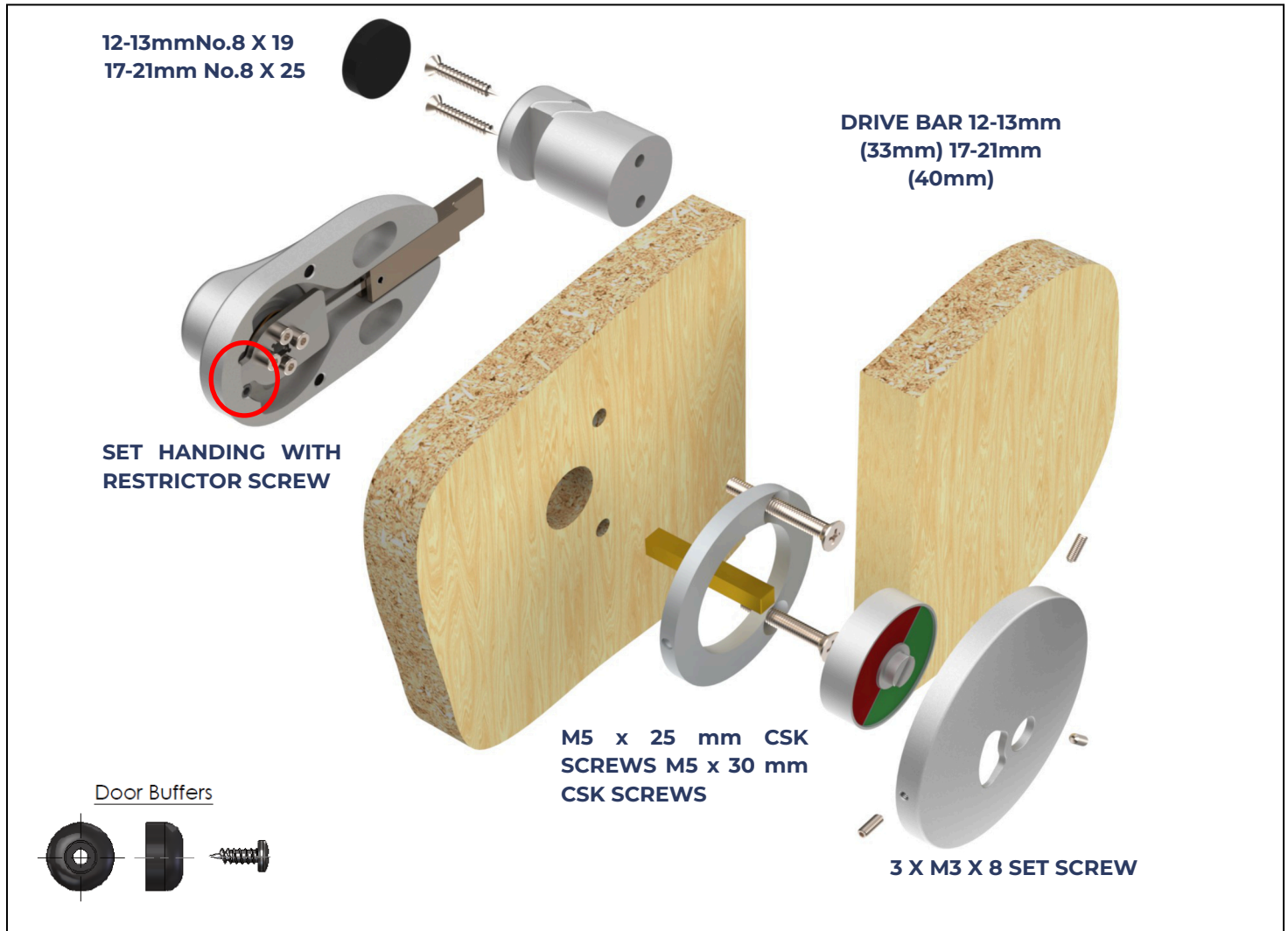

1. Decide the centre height of the indicator bolt (this is usually a matter of personal preference). Mark off and machine the door as shown on the drawing.

NOTE the Indicator handing can be changed by moving the position of the movement restrictor screw. (see sketch above)

2. Fit the clamp ring screws through the clamp ring and door, checking they protrude approx 5mm.

Offer the shoot bolt assembly to the door, align the screws holes and tighten firmly, clamping the indicator bolt to the door. Fit the drive bar through the door and into the drive square in the indicator handle. Slot the signal drive pocket over the protruding end of the drive bar making sure red/green signal is aligned in the correct orientation when the face plate is fitted. Fit the face plate over the clamp ring and secure in place with the 3 grub screws.

3. Fit the two rubber buffers onto the back of the fascia approximately 150mm from the line of the top and bottom of the door.

4. Close the door and slide the bolt into the locked position. Offer the keep into position and pilot drill the 2 screw holes. Ensure the keep is in the correct orientation for the panel thickness and secure with No. 8 screws. NOTE the screw lengths for the different panel thicknesses. Fit the self adhesive buffer to the keep.

5. Check the operation of the bolt.

Pacific Indicator Bolt 19mm - SAA

Product Code: 10501-19MM-SAA

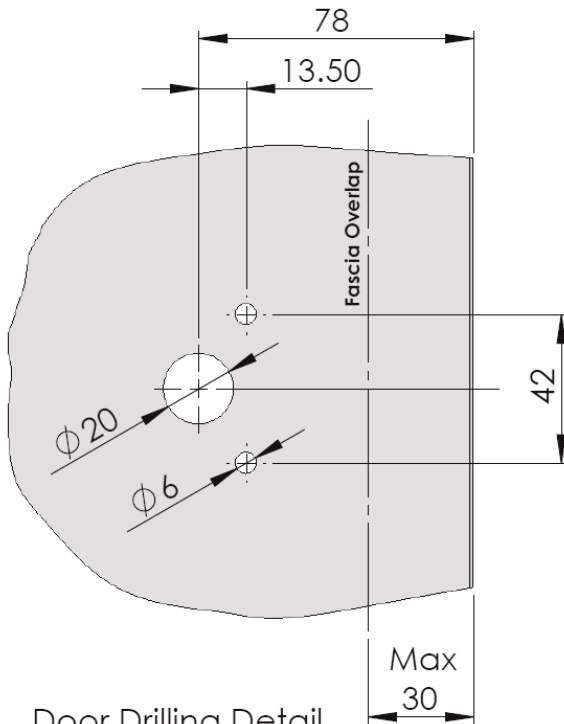

Door Drilling Detail
Inward Opening Door
For outward opening detail see sheet 2

INWARDS OPENING DRILLING DETAIL

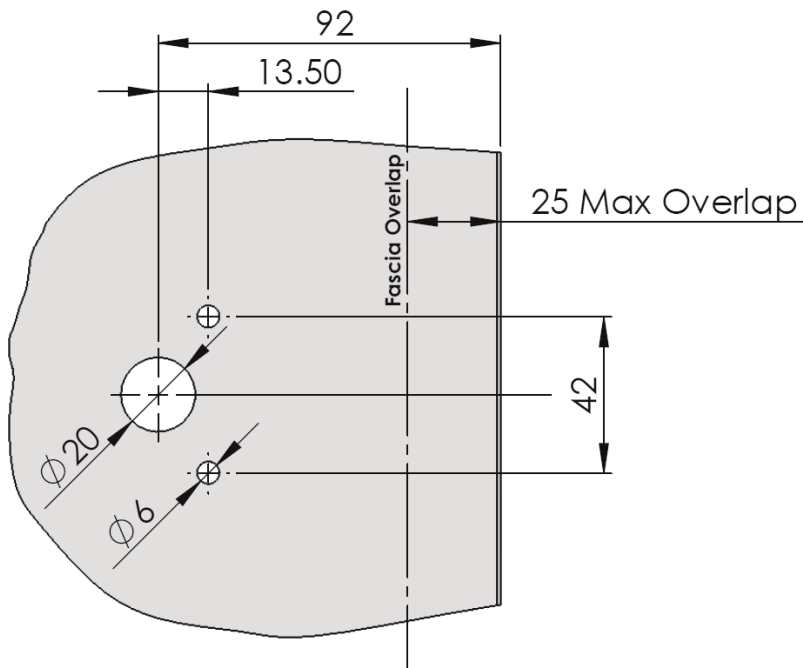

Door Drilling Detail
(outward Opening Doors)

OUTWARDS OPENING DRILLING DETAIL

4b. Close the door and slide the bolt into the locked position. Offer the keep into position and pilot drill the 2 screw holes. Secure with the No. 8 screws provided.
NOTE: the screw lengths for the different panel thicknesses vary.

5b. Check the operation of the bolt.